

Pg 144

Abram Weaver

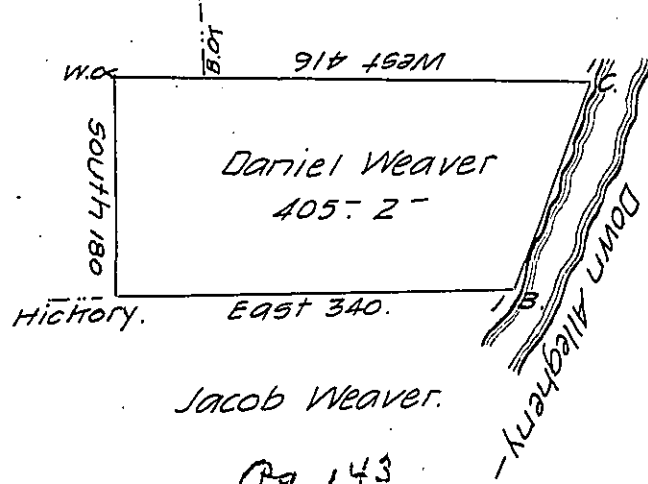

Pg 143

Courses on the River from B. upwards to C.

N. 27° E. 48.

N. 23° E. 123.

N. 14° E. 25.

196-

Surveyed on the 22nd day of June 1795 the above described Tract of Land in District No. 6 in pursuance of a Warrant to Daniel Weaver dated 20th December 1793 Containing four hundred five acres, two perches and allowance of six per cent.

Saml Nicholson D.S.

To Daniel Brodhead Esqr

Surveyor General.

IN TESTIMONY that the above is a copy of the original remaining on file in the Department of Internal Affairs of Pennsylvania, made conformably to an Act of Assembly approved the 16th day of February, 1833, I have hereunto set my Hand and caused the Seal of said Department to be affixed at Harrisburg, this ~~twenty-fourth~~ day of ~~JUNE~~ 1907

Henry Howell
 Secretary of Internal Affairs.